

dabtastic
THE BULLET

USER MANUAL



Made in China

INTRODUCTION

Thank you for purchasing this vaporizer, this is the advanced complete baking vaporizer making the vaporization process very fast and pure, no combustion, which instantly destroy the key elements found in various herb and release a multitude of new chemical compounds.

Complete 3in1 baking vaporizer, adjustable voltage when connect with the wax tank to 3 voltage option mold. 5 temperature to choose when use the herb heating device. To ensure optimal performance and safety of your herb vaporizer, please read this entire manual for instructions.

FEATURES

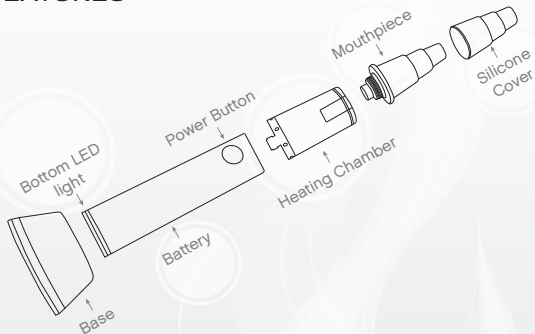

dabtastic

TURNING ON/OFF



USB Cable



Silicon Cover



Battery



Chamber



Mouthpiece



Base



Manual



Cleaning brush



Dab tool



Wax Tank
(Sell Separately)

PACKING CONTENTS

- ❖ 1 X Battery
- ❖ 1 X Heating Chamber
- ❖ 1 X Mouthpiece
- ❖ 1 X Silicone Cover
- ❖ 1 X USB Cable
- ❖ 1 X Base
- ❖ 1 X Manual
- ❖ 1 X Dab Tool
- ❖ 1 X Cleaning Brush
- ❖ 1 X Gift Box

dabtastic

SPECIFICATIONS

- ❖ Device Size 122*22*22mm
- ❖ Capacity & Output 2200mAh Li-polymer battery, 5V, 1A
- ❖ Resistance 0.5~0.7 ohms
- ❖ Lock/Unlock Press power button 5 times in rapid succession
- ❖ Heating Up Time Within 20 seconds
- ❖ Safety Power Time 5 Minutes auto-shut off
- ❖ Charging Time Around 3 hours
- ❖ Low Power Bottom red LED light alternating flash 5 times
- ❖ Safeguard Dual PCB/IC protection

INSTRUCTIONS

❖ Loading the device:

A. For Dry herb

- Screw out the mouthpiece from the heating chamber
- Fill the chamber full with dry herb(always make sure to finely grind your materials before vaporizing).But don't over-pack because proper airflow is needed for best results.
- Re-attach the mouthpiece back once your device has been applied. (Put the silicone cover on the mouthpiece if you need to use bubbler)
- Click the power button 5 times to turn on, press the power button one times to switch the temperature.

Note: Vaporization may vary depending on type of material and temperature setting.

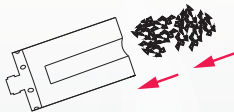

B. Fox Wax

- The battery can be matched with different kinds of wax tank.
We recommend you use our special Tallva to test it's better vapor.

C. For Oil

- The battery can support various oil tank in the market, please follow the oil tank manual.

❖ **Turning on/off the device**

- Turn on :

Once loading the device, press the battery button 5 times continuous and slowly within 3 seconds to turn on it.

Turn off:

Press the button 5 times again to turn off the device.

Auto shutdown:

the device has a safety power duration function, the unit will auto shutdown after 5 minutes of use. Simply press the button 5 times rapidly to re-activate the device.

❖ **Turning on/off the device**

- Turn on :

Once loading the device, press the battery button 5 times continuous and slowly within 3 seconds to turn on it.

Turn off:

Press the button 5 times again to turn off the device.

Auto shutdown:

the device has a safety power duration function, the unit will auto shutdown after 5 minutes of use. Simply press the button 5 times rapidly to re-activate the device.

❖ Battery Capacity Indication & Charging

- Battery Capacity Indication:

This device has a LED light on battery bottom, it will light on for 10 seconds then off. Different color indicate different battery power, as below:



Green LED light
70%~90% Power



Blue LED light
30%~70%



Red LED light
10%~30%

- Charging:

During operation, a low battery power will be indicated by alternate red light flashing 5 times on battery button and bottom LED light, then the device shutdown. That means the battery power less than 10%, you have to recharging the device. To charge, plug provided USB cable into the micro USB port. A slowly flashing red LED light indicates charging in process. The bottom LED green light flashing 10 times, then off means full charge. A full charge is recommended before first use and a full charge from empty to full may take around three hours.



❖ **Note:**

- The device contains lithium-ion battery, please be sure to discard of them in proper receptacle. Don't overcharge it and short circuit it.
- Incompatible chargers may carry a different voltage, which may be a fire hazard. For this reason, we strongly request to use supplied charger along with the package. The use of any charging unit with a different voltage will void the limited warranty offered on the device.
- In order to prevent overheating, pls don't leave the charger plugged in overnight.

❖ **Temperature Setting For Dry Herb**

- This device has five temperate settings: 375F/390F/405F/ 420F/435F. When the device turn on, your temperature will be set at 375F, the blue light will appear on the side of battery (the first position). In the meantime, a flashing blue LED light will appear on battery button to indicating that your device start heating up process. When the indicator light become solid blue ,the desired temperature is reached.(we recommend you wait 3 or 4 seconds before inhaling through the mouthpiece).
- To change your setting temperature, pls press the power button once, the battery side LED light will change position to indicate the heating selection. Keep pressing power button to cycle through the heating setting.

● 435°F

● 420°F

● 405°F

● 390°F

● 375°F

❖ Voltage Setting For Wax & Oil

- This device has three voltage options for wax/oil(3.7V/3.9V/4.2V). When connect the wax or oil tank(You can buy it from local market), it turns to voltage setting mold automatically. Click the battery button five times to turn on/off. Click the battery button four times change to your desired voltage. Press and hold the battery button for vapor.

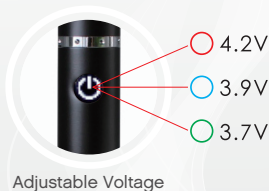

❖ Voltage Setting For Wax & Oil

- This device has three voltage options for wax/oil(3.7V/3.9V/4.2V). When connect the wax or oil tank(You can buy it from local market), it turns to voltage setting mold automatically. Click the battery button five times to turn on/off. Click the battery button four times change to your desired voltage. Press and hold the battery button for vapor.

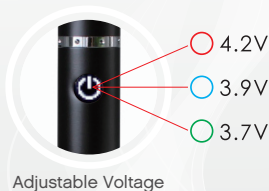

CLEANING AND MAINTAINING THE HERB TANK

- Lock the device before cleaning.
Remove the mouthpiece and empty the chamber completely.
- To cleaning the heating chamber, please use the cleaning brush to gently remove any excess particles inside and around the chamber.

Note:

1. While using the device, portions of the device may reach high temperatures. Don't clean or disassemble the device until all portions of the device has cooled completely.
2. Don't immerse the herb tank in liquid of any kinds, it will damage the heating element.

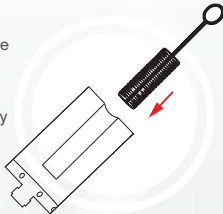

IMPORTANT SAFETY INFORMATION

❖ Warning

- Internal parts of the device reach high temperatures. Use caution when accessing the chamber.
- Keep out of reach of children.
- Do not dismantle the device for the cleaning and maintenance instructions, which is beyond of warranty service.
- Do not touch the heating cup for at least 10 minutes after use as it will be very hot.
- Use only provided power supply to charge battery, use of any other power supply is dangerous and which can't call for warranty.

This vaporizer is designed for legal dry herb as an aroma therapy device, not for Tobacco use. Refrain from using this product if you are under the legal smoking age in your state, pregnant or nursing. This product is not an aid for smoking cessation.

WARRANTY INFORMATION

The device has 6 months limited warranty which covers your vaporizer against defects in manufacturing, parts and labor. If any quality issue is during the warranty coverage, we will fix or replace it. The unit must be returned in its original packaging along with receipt of purchase.